

Scottish Borders Council
Town And Country
Planning (Scotland) Act
1997

REFUSED

subject to the
requirements of the
associated Decision
Notice

KEY:
LAND OUTLINED IN RED = APPLICATION SITE
LAND OUTLINED IN BLUE = OWNED BY APPLICANT

Ordnance Survey License No. - 100022432

Location Plan

Scale: 1:1250



CLIENT:
Mrs C Redpath

PROJECT:
Proposed New Dwellinghouse at Plot 4
Hume Holdings, Hume

DRAWN: TD	SCALE: 1:1250	DATE: 29/04/2021	A4
--------------	------------------	---------------------	----

TITLE:
Location Plan

Richard Amos Ltd.

**Chartered Architectural and Building
Surveying Services**

2 Golden Square, Duns, Berwickshire, TD11 3AW,
Tel: (01361) 882599, Fax: (01361) 882577,
E-Mail: ra@richardamosltd.co.uk

Registered Office 2 Golden Square, Duns, Berwickshire, TD11 3AW.
Registered in Scotland, Company No. 240332 V.A.T. Reg. No. 502 4656 71

DRAWING NO:
19/B472/PL04

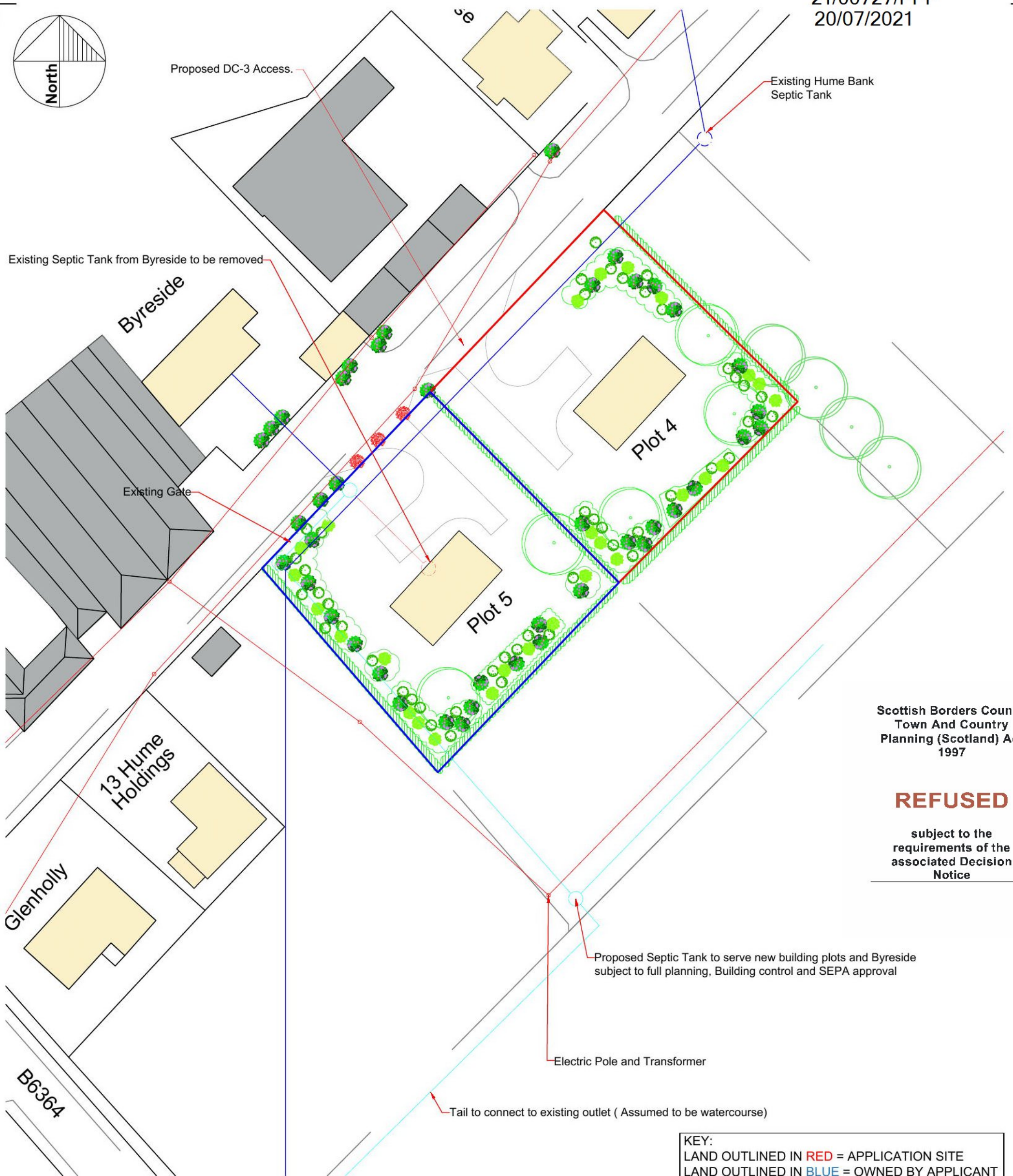
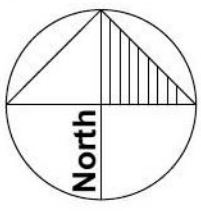

Scottish Borders Council
Town And Country
Planning (Scotland) Act
1997

REFUSED

subject to the
requirements of the
associated Decision
Notice

Site Plan
Scale: 1:500



KEY

- Existing Drainage
- Proposed Drainage
- Overhead Electrical Cables

KEY:
LAND OUTLINED IN RED = APPLICATION SITE
LAND OUTLINED IN BLUE = OWNED BY APPLICANT
Ordnance Survey License No. - 100022432

CLIENT: Mrs C Redpath		<p>Richard Amos Ltd. Chartered Architectural and Building Surveying Services</p> <p><small>2 Golden Square, Duns, Berwickshire, TD11 3AW, Tel: (01361) 882599, Fax: (01361) 882577, E-Mail: ra@richardamosltd.co.uk</small></p> <p><small>Registered Office 2 Golden Square, Duns, Berwickshire, TD11 3AW. Registered in Scotland, Company No. 240332 V.A.T. Reg. No. 502 4656 71</small></p>	
PROJECT: Proposed New Dwellinghouse at Plot 4 Hume Holdings, Hume			
DRAWN: TD	SCALE: 1:500	DATE: 28/04/2021	A3
TITLE: Proposed Site Plan			DRAWING NO: 19/B472/PL06
DO NOT SCALE FROM THIS DRAWING. These drawings are subject to copyright laws: © Richard Amos Ltd			This drawing is for Planning Purposes Only